

## Adapter-Plates ISAP-S

Standard dimensions 195 × 195 mm, hole matrix spacing 75 mm

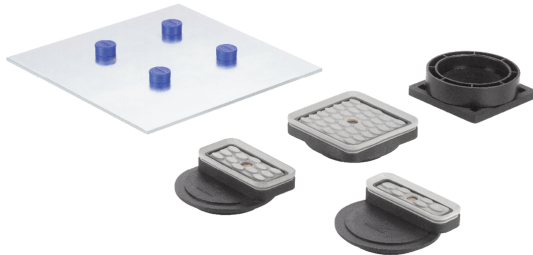

Adapter-Plates ISAP-S

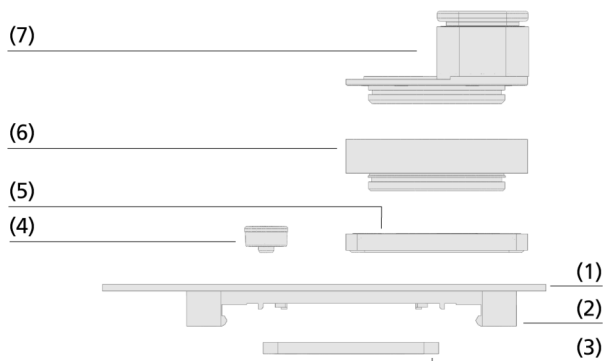

System design Adapter-Plates ISAP-S

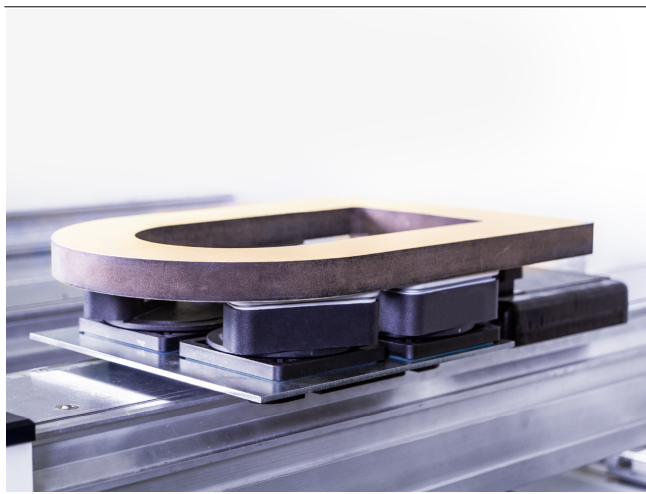

Adapter-Plates ISAP-S with Mono-Base and suction cups for clamping of curved boards

### Suitability for industry specific applications

#### Application

- Hose-free Schmalz clamping system for console tables from SCM / Morbidelli, fully compatible with original equipment
- The Adapter-Plates are positioned directly onto the vacuum supply on the consoles
- Equipping the ISAP-S with up to four additional Mono-Bases and suction cups
- Particularly suitable for narrow and curved workpieces with small suction surfaces and delicate molds
- Overall height can be adapted with the spacer rings
- TVN System from SCM = S4 System from Schmalz (width of the console 109 mm)

#### Design

- Adapter-Plate (1) base plate
- Dovetail mount (2) for mechanical pre-fastening on SCM / Morbidelli consoles
- Sealing frame (3) optimized to allow easy repositioning of the Adapter-Plate on the console; and sealing magnet (4)
- Mono-Base (5) for positioning on top of the vacuum openings of the Adapter-Plate and suction cup (7) for fixing the workpiece are available as accessories
- Spacer ring (6) for adjusting the height to the machining height of the machine

#### Product highlights

- Ideal for narrow and curved workpieces, as plates and vacuum blocks can be flexibly combined
- Freely positionable suction cups and Mono-Bases allow almost any clamping layout
- Mixed operation with standard vacuum blocks possible for even more flexibility and short set-up times
- Accessories and spare parts can be replaced quickly, easily and cost-effectively without tools

# Adapter-Plates ISAP-S

Standard dimensions 195 × 195 mm, hole matrix spacing 75 mm

## Designation code Adapter-Plates ISAP-S

<b>ISAP-S4</b>	–	<b>195x195x11</b>
<b>1</b>		<b>2</b>

### 1 – Abbreviated designation

Code	Type
ISAP-S4	Innospann adapter plate, SCM/Morbidelli TVN-System

### 2 – Dimensions

Code	LxWxHeight in mm
195x195x11	195x195x11

The Adapter-Plates ISAP-S4 are delivered assembled. The products consist of:

- main body of aluminum
- sealing magnets for closing the vacuum openings

Available spare parts: sealing magnet, wear part set

Available accessories: Mono-Base, spacer ring, suction cup

## Ordering data Adapter-Plates ISAP-S

Type	Part no.
ISAP-S4 195x195x11	10.01.14.00231

## Ordering data Spare parts Adapter-Plates ISAP-S



Type	Spare parts	Part no.
ISAP-S4 195x195x11	Sealing magnet	ISMST 19-7 4ISMST 10.01.14.00847 

Type	Spare parts	Part no.
ISAP-S4	Set of parts subject to wear	Bottom sealing frame VST VCBL-S DI-RA 10.01.12.03318

## Ordering data Accessories Adapter-Plates ISAP-S

Type	Part no.
Mono-Base	ISMB 80x80x8 10.01.15.00188 

Type	Part no.
Spacer ring, Innospann	ISZR-V 80x15 10.01.15.00052

Type	Part no.
Cup	ISCUP Cup 1 80x80x16 10.01.15.00209 
Cup	ISCUP Cup 2 80x40x16 10.01.15.00210 
Cup	ISCUP Cup 3 80x28x16 10.01.15.00211 

## Adapter-Plates ISAP-S

Standard dimensions 195 × 195 mm, hole matrix spacing 75 mm

### Design data Adapter-Plates ISAP-S

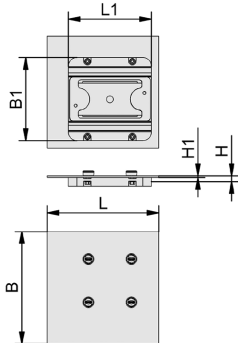

ISAP-S4

### Design data Adapter-Plates ISAP-S

Type	B [mm]	B1 [mm]	H [mm]	H1 [mm]	L [mm]	L1 [mm]
ISAP-S4 195x195x11	195	145	11	28	195	145